

CLASSIC 2.0

Pedometer Instructions



FEATURES

- Records steps
- Large digit
- Accumulates the total step
- Heavy duty clip securely attaches to waistband or belt
- Lightweight
- No sound when counting
- Avoid not valid step counting

#BS628



WHERE TO POSITION THE PEDOMETER

1. Clip the unit to your belt or the top of your shorts, trousers or slacks as near as possible to your hip.
2. The unit also is able to count the steps correctly when the front of the main unit is placed in the angle of less than 60° (shown as below figure 1) or the unit is not parallel to the ground but is placed in the angle of less than 30° (shown as below figure 2)

Figure 1

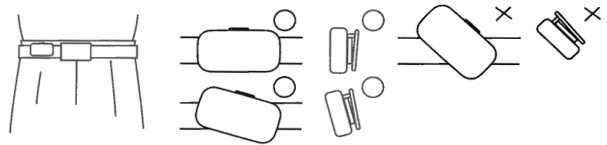
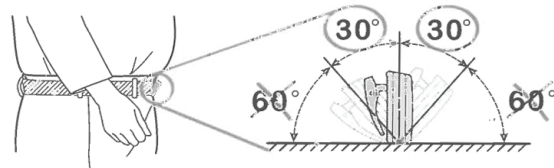

Figure 2



AVOID NOT VALID STEP COUNTING

The unit's display will not change or display steps until after you have walked for more than 6 steps.

TO RESET THE DISPLAYS

To reset the step, press the **B** button.

To reset the total step, press the **A** button and hold on 5 seconds.

TO READ THE TOTAL STEP

Press the **A** button not over 2 seconds and you will see your total step.

HOW TO REPLACE BATTERY

Please refer to following diagram to replace the battery with proper type when display dims.

Battery type: CR2032

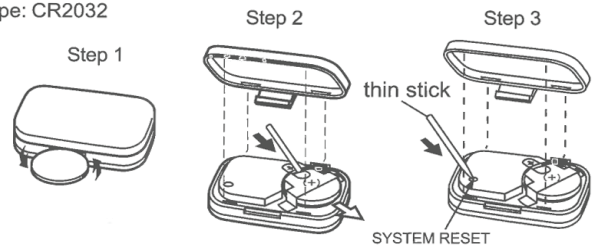

Step 1. Open the battery cover with a coin.

Step 2. Take out the battery with a thin stick that is not easily breakable and replace the new battery.

Step 3. Press the SYSTEM RESET button with a thin stick that is not easily breakable and put the battery cover back on the pedometer.